



Prince of Peace  
Christian School  
*& Early Learning Center*

# NEW FAMILY GUIDE



# TABLE OF CONTENTS

---

## **THE BASICS** Page 3-6

Main Events Calendar  
Eagle Express  
2010/2011 School Year Information Web Page  
School Store  
Parent Place  
Parent/Student Handbook  
Uniforms  
Hooded Sweatshirt  
Special Dress Days  
Back to School Check List  
Lunch  
Special Lunch Days  
Staff Directory  
ParentsWeb  
Daily Schedule  
Security  
Chapel  
Report Cards  
Eagles' Club (Boosters)  
Absentee Policy  
Cell Phones  
Parent Participation  
Cookie Wednesday  
Ice Cream Friday  
Shop for POP  
The ZONE

## **EARLY LEARNING CENTER** PAGE 7

Important Dates  
Nap Mat  
Item Check List

## **PRESCHOOL** PAGE 8-9

Special Events  
Important Dates

## **LOWER SCHOOL** Page 10 - 11

Important Dates  
WINGS  
Eagle's Nest  
Reading Recovery  
Leadership Day  
Parent Orientation  
Athletics  
Gymnastics  
Extracurricular Activities

## **MIDDLE SCHOOL** Page 12-13

Important Dates  
End-of-Year Celebration  
Class Trips  
Athletic Opportunities  
Extracurricular Activities  
Eighth Grade Recognition  
PE Uniforms

## **HIGH SCHOOL** Page 14 - 15

Important Dates  
High School Meet and Greet  
Class Fund-Raisers  
Off Campus Lunches  
Success Center  
College Days  
Counselor  
Advanced Placement (AP) Textbooks  
Extracurricular Activities  
Athletic Opportunities

## **DEVELOPMENT** Page 16

Overview  
Distribution of Funds  
Discover POP Tour  
Fine Arts Center

## **MAJOR SCHOOL EVENTS** Page 17

POP Rally  
Grandparents' Day  
Auction  
Spring Carnival

## **CARPPOOL MAPS** Page 18, 19

# IMPORTANT DATES



August 15  
**Opening Worship**  
4:00 p.m., Sanctuary

**Welcome Back Picnic**  
Immediately following Opening Worship  
*Please RSVP by August 13.*

August 17  
**First Day of School**

**PTF Welcome Breakfast & POP 101 for New Families**

August 19  
**K/1st Parent Orientation**

August 24  
**2nd/3rd Parent Orientation**

August 26  
**PS Parent Orientation**  
**4th/5th Grade and HS Parent Orientation**

September 6  
**Labor Day**

September 9  
**MS Parent Orientation**

September 24 and 25  
**Homecoming**

September 28-October 1  
**Individual/Yearbook Pictures**

September 29  
**Muffins with Mom**  
7:30 a.m., Fellowship Hall

October 5  
Annual Pledge Event  
**POP Rally**

October 7- 8  
**Parent Teacher Conferences**  
Early Release - 11:30 a.m. (preschool 3 - Grade 12)

November 18-19  
**Grandparents' Days**

November 22-26  
**Thanksgiving Break**  
No School (Preschool 3 - Grade 12)

November 25-26  
**No Early Learning Center (ELC) or The Zone**

December 20 - January 1  
**Christmas Break**  
No School (Preschool 3 - Grade 12)

December 23 and 24 and December 30 and 31  
**No ELC or The Zone**

January 3  
**School Resumes**

January 6  
**Kindergarten Info Night**

January 9  
**2 p.m. Open House**

January 14  
**Donuts with Dad**  
7:30 a.m., Fellowship Hall

January 17  
**Martin Luther King, Jr. Day**  
No School (Preschool 3 - Grade 12)

February 18  
**Parent Teacher Conferences**  
No School (PS - Grade 12)

February 21  
**Presidents' Day**  
No School (Preschool 3 - Grade 12)

February 22-25  
**Achievement Tests**

March 14-18  
**Spring Break**  
No School (Preschool 3 - Grade 12)

March 29-30  
**Class Pictures**

April 9  
**Annual Auction**  
**"Lone Starry Night"**

April 22 and 25  
**Easter Break**  
No School, ELC or The Zone

May 1  
**School Carnival**

May 24  
**Used Uniform Sale**

**Last Day of Preschool**

May 27  
**Last Day of School for Grade K -11**

May 27  
**High School Graduation**  
7:00 p.m.

May 30  
**Memorial Day**  
No ELC or The Zone

# THE BASICS

## EAGLE EXPRESS

POPCS' main source of communication to school families is through the Eagle Express. This weekly electronic publication is e-mailed to POPCS families every Friday during the school year. The newsletter includes important information such as upcoming events, school updates, policy changes, weekly calendar and development news. POPCS' distribution list is comprised of parent e-mail addresses submitted with their child(ren)'s application(s). If you did not include an e-mail address or it has changed, please send an e-mail with the name(s) and grade level(s) of your child(ren) to Joyce Lonquist, [joyce.lonquist@princeofpeace.org](mailto:joyce.lonquist@princeofpeace.org).

A version of the Eagle Express will be posted online, at [www.popcs.org/school/EE](http://www.popcs.org/school/EE). This version will not include last names or contact information.

## 2010/2011 SCHOOL YEAR INFORMATION WEB PAGE

Please visit the 2010/2011 School Year Information web page. This can be accessed at <http://www.popcs.org/resources/index.html>. This page provides information you will need to know before the first day of school. To access this web page, go to the school web site and click on the "2010/2011 School Year Information" button located on the right hand side of the "Important Information" section of the website.

## SCHOOL STORE

Visit the school store to purchase hard-to-find school supplies, nap mats and much more. You may also purchase Spirit Wear - shirts, hats, sweatshirts and stadium chairs. The school store is located in the Fellowship Center. During the school year the hours of operation are 8:00 - 9:00 a.m. and 3:00 - 4:00 p.m. daily. Please visit the 2009/2010 School Year Information web page to view the school store's summer hours.

## PARENT PLACE

The Parent Place is located in the niche in the main school entrance. That is where you will find important forms and drop off boxes.

## PARENT/STUDENT HANDBOOK

All parents and students are expected to read the handbook, familiarize themselves with the contents and support the policies of Prince of Peace Christian School. Copies of the handbook may be downloaded from the school web site.



## UNIFORMS

Uniforms are required for all students in Preschool – Grade 12. All uniforms should be purchased through Campus Outfitters. The required dress uniform must be worn for Chapel days and other days as designated by the teacher or administrators. On all other school days, students may choose uniform items from the optional list for the appropriate grade level.

**campusoutfitters**  
School Uniforms & More

101 S. Coit Road, Richardson, TX 75080  
[www.campusoutfitters.com](http://www.campusoutfitters.com), school code: PR1470  
1-888-9230700

POPCS uniform guidelines can be found online,  
[www.popcs.org/resources/uniform](http://www.popcs.org/resources/uniform).

## HOODED SWEATSHIRT

The Eagles' Club hooded sweatshirt is a very popular item which may be worn daily, unless otherwise specified by a teacher or administrator. Sweatshirts are available for purchase at the school store for \$37 or \$30 if you are a Eagles' Club member.

## SPECIAL DRESS DAYS (Preschool - Grade 12)

Generally, the last Friday of each month will be designated as Spirit Day. Special Dress for Spirit Days will be POPCS t-shirts/sweatshirts and appropriate jeans. Athletic shorts may be worn on Spirit Days. Jeans should not be low-riding, baggy or torn. Sandals or "flip-flops" may not be worn. Parents and students should read the Eagle Express for reminders about Spirit/Special Dress Days.

## BACK TO SCHOOL CHECK LIST

Please complete the following tasks prior to school beginning:

- Complete and return all forms inside the summer packet. Summer packet information can be downloaded on the 2010/2011 School Information web page. Please return the following completed forms before school begins: emergency contact, student health information, emergency medical treatment, field trip release and grandparents' day forms (lower school and middle school).
- Complete summer reading requirements.
- Provide the school's clinic with the required medical supplies.
- Scan your driver's license with the main school receptionist.
- Purchase all items on the school supply list.

## LUNCH (ELC - Grade 12)

All students, will have lunch on campus. Students are required to bring a sack lunch from home or purchase a meal from the school's caterer, Signature Services. Lunches brought from home should be nutritious and easily managed by the child. No fast food or pizza may be brought as a lunch. Students are encouraged to bring juice, sports drinks or water, rather than soft drinks.

Signature Services will provide hot lunches 5 days per week for a fee. At the beginning of the school year, all students will have a lunch account established. To use this account, parents should deposit \$25. This allows students to enjoy a hot lunch if they forget their sack lunch at home.

Hot lunches, milk and/or juice purchases will be debited from the student's account at the time of purchase. The student's account should be replenished when it has a balance of \$15 or less. Parents will be notified. At the end of the school year, all balances will be refunded or rolled over to the next school year. Please notify POPCS if you do not wish for your child to have a lunch account.

Monthly menus and lunch forms are available on the school web site, [www.popcs/resources/menu](http://www.popcs/resources/menu). Complete information on Signature Services can be found on our website at the 2009-2010 School Info link.

## SPECIAL LUNCH DAYS (K-5TH)

Two days during the school year will be designated as "Special Lunch Days", per grade. On these days, parents are allowed to bring fast food for their children.

## STAFF DIRECTORY

A complete school staff directory is available online, [www.popcs.org/school/contact](http://www.popcs.org/school/contact). In most instances, the e-mail address for teachers and staff members is the first

name dot last name @princeofpeace.org. (example: for Jane Doe, the address would be jane.doe@princeofpeace.org).

## PARENTSWEB (ELC - Grade 12)

ParentsWeb allows parents access to their child's weekly grade report, assignment information, classroom calendar, athletic information and much more. To access ParentsWeb, go to <https://www.renweb.com/login.htm>. Our school i.d. is, "prince-tx". Grade information will be posted on Mondays by 5:00 p.m. for the previous week. Report cards, Grade 1-12, will be posted online.

## DAILY SCHEDULE SECURITY

Our top priority at POPCS is to provide a safe learning environment for our students. Prior to entering the school, all parents and visitors must check in at the main school receptionist desk, which is located just inside the main school entrance. Visitors will receive a badge to wear while in the building. The first time you check in, you will be required to provide a state driver's license or state-issued identification card.

Early Learning Center	7:00 a.m. - 6:00 p.m.
Half-Day Preschool	8:15 a.m. - 11:15 a.m.
Preschool, K-Prep & Kindergarten	8:15 a.m. - 3:00 p.m.
Grades 1 - 5	8:15 a.m. - 3:15 p.m.
Grades 6-12	8:00 a.m. - 3:30 p.m.

**Due to long lines on the first day of school, we recommend you have the main school receptionist scan your driver's license prior to the beginning of school.**

## CHAPEL

During weekly chapel services, students and staff members sing, pray and participate in biblically-based lessons. School parents and visitors are invited to attend. Weekly chapel schedules are printed in the Eagle Express. Chapel offerings are taken each week which support Christian mission projects around the world.



### Chapel Schedule

**Preschool & K-Prep:** Tuesday or Wednesday  
**Kindergarten – Grade 12:** Thursday

# THE BASICS

---

## REPORT CARDS (Grade 1 - 12)

Report cards will be posted on ParentsWeb at the end of each grading period. Report cards will be held and RenWeb accounts deactivated if your child has any unpaid tuition/fees or unreturned school items - textbooks, athletic uniforms and/or library books.

## EAGLES' CLUB (Boosters)

The Eagles' Club supports student athletes, coaches and the athletic department by facilitating communication to parents and conducting fund-raisers to enhance the athletic department. Membership levels and prices vary depending upon your family's preference. Membership forms are available in the Parent Place and online at, [www.popcs.org/school/athletics/eaglesclub](http://www.popcs.org/school/athletics/eaglesclub). For more information, please contact the athletic department.

## ABSENTEE POLICY

Please notify the school when your child is absent, arriving late or leaving early.

### Early Learning Center & Lower School

Contact: Front Desk Receptionist  
[school.receptionist@princeofpeace.org](mailto:school.receptionist@princeofpeace.org) | 972-447-0532 ext. 461

### Middle School

Contact: Robin Muilenburg  
[robin.muilenburg@princeofpeace.org](mailto:robin.muilenburg@princeofpeace.org) | 972-447-0532 ext. 491

### High School

[highschool@princeofpeace.org](mailto:highschool@princeofpeace.org) | 972-447-0532 ext. 342

If a student is absent from school for all or part of a day, it's the student's responsibility to check ParentsWeb to find out about any missed assignments. In most cases, students will have one day for each day absent to complete make-up work.

## CELL PHONES

Pagers and cell phones are allowed on campus, but must be turned off and kept in the student's locker. Students are not allowed to use cell phones during school hours, 8:00 a.m. - 3:30 p.m. Parents are asked to contact the school with messages for their children. **While driving on campus, please refrain from using cell phones, and drive slowly.**

## PARENT PARTICIPATION

Volunteering at POPCS is a wonderful way to be involved in your child's education. Most parental participation is coordinated through the Parent Teacher Fellowship (PTF) organization. The High School division of the PTF organization is the POSSE (Parents Of Senior high Students and Educators).

To get involved, complete and return the Volunteer Finder form to the Parent Place. Forms are available in Parent Place and online, [www.popcs.org/school/resources](http://www.popcs.org/school/resources). For more information about volunteering, please contact Jackie Walls at [texasjmw@aol.com](mailto:texasjmw@aol.com) or 972-731-7910.

## COOKIE WEDNESDAY

Freshly baked Otis Spunkmeyer cookies, chocolate chip and sugar, are available for \$1 every Wednesday after school in front of the School Store, which is located in the Fellowship Center.

## ICE CREAM FRIDAY (K - Grade 12)

Students can enjoy an ice cream treat on Fridays during lunch for a \$1. To ensure your child can enjoy a treat every Friday, ice cream passes will be sold at the beginning of the school year. Order forms are available on the 2010/2011 School Year Information web page.

## PIZZA PASS (K - Grade 12)

Pizza is sold by the High School on select Friday's. Pizza Pass Forms are available online and in the Parent Place. Drinks are not provided.



## SHOP FOR POP

The Shop for POP program allows families to earn money for POPCS. The school purchases major retailers' gift cards for a discounted price and sells the cards at face value. The revenue helps support PTF. Shop for POP orders are placed every two weeks. Orders must be returned to the Parent Place by Tuesday before 9:00 a.m. Orders will be ready for delivery/pick up on the following Friday. Forms and order dates can be found at [www.popcs.org/school/shopforpop](http://www.popcs.org/school/shopforpop).

## THE ZONE (Preschool 3 - Grade 5)



The Zone is a fun program for students before and after school, 7:00 – 8:00 a.m. and/or 3:15 – 6:00 p.m. The Zone Holiday Days are available when school is not in session due to teacher in-services and holidays. Additional fees apply.

# EARLY LEARNING CENTER

## IMPORTANT DATES

August 17  
**First Day of New Classes**

October 8  
**ELC Closed - Teacher In Service Day**

October 5  
Annual Pledge Event  
**POP Rally**  
7:00 p.m.

November 11  
**Parent Stone Soup Feast**  
Parents join their children for lunch.  
11:00 a.m. - 12:00 p.m.

November 22 - 26  
**Thanksgiving Break**

November 25 and 26  
**ELC and Zone Closed**

December 17  
**Baby Jesus Birthday and Christmas Concert**

December 23-24 and January 30-31st  
**ELC Closed**

February 14  
**ELC Valentine Exchange/Party**

April 22 and 25  
**ELC Closed for Easter**

May 30  
**ELC Closed Memorial Day**

July 4  
**ELC Closed**



## ITEM CHECK LIST

### Infants

- 1 large container of baby wipes, monthly
- 3 containers of disinfectant wipes
- 2 pump bottles of hand soap
- 1 pump bottle of infant hand and body wash
- 3 containers of sani hand wipes
- 5 day supply of diapers
- 1 container of your child's ready-made formula
- 2 outfits, socks, bibs, etc.
- 1 package (2 count) of permanent markers
- 2 receiving blankets
- Full size plastic bib
- Diaper cream or powder, if necessary

### Toddlers

- 1 large container of baby wipes, monthly
- 3 containers of disinfectant wipes
- 3 pump bottles of hand soap
- 3 containers of sani hand wipes
- 2 no-spill sippy cups
- 5 day supply of diapers
- 2 outfits, socks, bibs, etc.
- 1 package (2 count) of permanent markers
- 1 nap mat
- 24 servings of a nutritional snack, monthly
- Full size plastic bib
- Diaper cream or powder, if necessary

### Two Year Olds

- 1 large container of baby wipes, monthly
- 3 containers of disinfectant wipes
- 3 pump bottles of hand soap
- 3 containers of sani hand wipes
- 2 no-spill sippy cups
- 5 day supply of diapers
- 2 outfits (4 if potty training), socks, bibs, etc.
- 1 package (2 count) of permanent markers
- 1 nap mat
- 1 box of chubby crayons
- 1 package of washable classic markers
- 24 servings of a nutritional snack, monthly
- Full size plastic bib
- Diaper cream or powder, if necessary

## NAP MAT

All students in the Toddler - Two year old programs are required to purchase a "Nap Mat" from the school store for \$35. All nap mats will need to be laundered on a regular basis.

# PRESCHOOL

---

## LEADERSHIP DAY (Preschool)

Once a month students will be assigned a leadership day. On this special day, the selected student may bring a nutritious snack and his/her favorite item for show-and-tell. All snacks should consist of healthy food and a light-colored natural juice or milk. Cups and napkins are provided.



## GYMNASTICS (Preschool - Grade 5)

During the school day, students have the option of attending gymnastics once a week during recess or PE times. The program is designed to develop the student's strength, flexibility, coordination and cardiovascular endurance. Interested students may participate in the first class for free. Enrollment forms are available online and in the Parent Place. Completed forms and payment may be returned to the Gymnastics box located in the Parent Place.

## CHAPEL

Preschool Chapel is on Wednesday mornings at 9:30 a.m.

# PRESCHOOL

---



## IMPORTANT DATES

September 23

**Preschool “Sleepy Time” Stories**

7:00 p.m.

October 7

**Early Release**

11:30 a.m.

October 8

**No School, ELC - 12**

**Parent/Teacher Conferences**

October 29

**PS/KP Orange Day**

November 10

**P3/MWF P4 Parent Stone Soup Feast**

**Parents join their children for lunch.**

11:00 a.m. - 12:00 p.m.

November 11

**P4/KP Parent Stone Soup Feast**

**Parents join their children for lunch.**

11:00 a.m. - 12:00 p.m.

November 19

**PS/KP Grandparents’ Day**

December 17

**Baby Jesus Birthday and Christmas Concert**

January 6

**Kindergarten Info Night**

January 14

**Donuts with Dad**

7:30 a.m.

January 27

**PS/KP close at 11:30 for PS Conference**

January 28

**PS/KP Closed for PS Conference**

February 14

**PS/KP Valentine Exchange/Party**

March 10

**PS/KP Math Night**

6:30 p.m.

May 24

**Closing Program/Last Day of School - Early Dismissal at 11:00 a.m.**

# LOWER SCHOOL

## IMPORTANT DATES

August 17

First day of school

August 19

**Parent Orientation: Kindergarten and 1st Grades**

Individual classrooms

August 24

**Parent Orientation: 2nd and 3rd Grades**

Individual classrooms

August 26

**Parent Orientation: 4th and 5th Grades**

7:00 p.m. Individual classrooms

March 2

**Middle School Information**

Fifth grade parents should attend.  
8:30 a.m. and 7:00 p.m.



## EAGLE'S NEST (Grade 3 -5)

The Eagle's Nest assists students who have special learning styles and/or are in need of remedial strategies in reading, math and study skills. Students attend the Eagle's Nest classes every school day. Participation in this program requires an additional fee.

## EAGLE'S NEST READING (Kindergarten - Grade 2)

The Reading Recovery program gives students extra assistance in phonology, reading comprehension, reading fluency, vocabulary building skills, handwriting and written expression. Students attend the program during non-core curriculum times.

The Reading Recovery teacher will administer diagnostic testing to each student recommended for the program. A precise reading level will be obtained as well as an instructional profile to design an individualized plan for each child. Participation in this program requires an additional fee.

## PARENT ORIENTATION

Parent Orientation meetings are critical for parents to attend. During these meetings, the entire school year volunteer opportunities are discussed and planned. Please bring your planner. You will also have the opportunity to meet with other parents and visit with your child's teacher.

## WINGS (Grade 1-5)

The WINGS program is designed for students who:

- Exhibit high performance capability in an intellectual or creative area.
- Demonstrate an unusual capacity for leadership.
- Excel in a specific academic field.

Students will attend WINGS for 2 to 3 hours a week, depending upon their grade level. Acceptance into the program requires students to go through a recommendation/testing process. Participation in this program requires an additional fee.

## ATHLETICS

Prince of Peace does not offer school sports until sixth grade, but many students join POPCS city league sports. Many students participate at the following clubs:

Town North YMCA	214-357-8431
Dallas North Soccer	972-480-8860
Plano Sports Authority	972-424-5437
Plano Youth Soccer	972-422-7972
Plano YMCA	972-378-9622
Prestonwood Sports Organization	972-820-5227



Students in sixth grade may join the middle school cross country and track teams for on campus practice. Students will have the opportunity to participate in team meets. For more

information, please contact the athletic department.

Sixth grade students interested in joining the tennis team should contact David Scott at: [scotttennis@tx.rr.com](mailto:scotttennis@tx.rr.com).



## GYMNASTICS (Preschool - Grade 5)

During the school day, students have the option of attending gymnastics once a week during recess or PE times. The program is designed to develop the student's strength, flexibility, coordination and cardiovascular endurance. Interested students may participate in the first class for free. Enrollment forms are available online and in the Parent Place. Completed forms and payment may be returned to the collection box located in the Parent Place.

## EXTRACURRICULAR ACTIVITIES

**All extracurricular activities require an additional fee.**

### **Pep Squad (Kindergarten - 4th Grade)**

All children who would like to promote school spirit should join the Pep Squad. Students will meet once a week after school beginning in September. The squad will perform at all pep rallies and at one varsity game. Enrollment is by semester.

### **Chess Program (Kindergarten - Grade 6)**

The after school Chess Program meets every Monday from 3:30 – 4:30 p.m. The program will help enhance each student's abstract thinking skills, problem solving ability and cognitive short/long term memory. The instructor has over nine years of experience teaching chess.

### **Drama Club (Grade 1 - 5)**

The after school drama club focuses on music, drama, dance and self-confidence. Students will present a play to an audience. Enrollment is by semester.

### **Destination ImagiNation (Grade 1 - 5)**

Destination ImagiNation is an academic competition that gives teams of students the opportunity to work together to use their imagination to solve challenges.

### **PSIA (Grade 1 - 8)**

The Private Schools Interscholastic Association (PSIA) allows students to participate in nineteen event categories such as art memory, vocabulary, spelling, storytelling, creative writing, on-site drawing and many more.

### **Martial Arts (Grade 1 - 12)**

The after school Karate program teaches students the fundamental Martial Arts principles with emphasis on discipline, structure and self-control. Classes are weekly and vary in length. Beginning classes do not involve fighting. The class is taught by an internationally certified Black Belt who has taught hundreds of children. Interested students may participate in the first class for free.

### **Science Club (Grade 3 - 4)**

Science Club meets once a month to share a hands-on activity. The meetings will be from 3:30 p.m. - 4:30 p.m. A snack will be provided. The day of the month will vary to allow different students to participate. Students need not attend all meetings.

**All extracurricular activities information will be available online or in the Eagle Express.**

# MIDDLE SCHOOL

## IMPORTANT DATES

August 12

### **Middle School Mixer**

9:00 a.m. - 3:30 p.m.

9:00 a.m., New students and sixth graders

10:00 a.m., Returning students

To participate in the event, return a completed Field Trip form to the HS office by August 11.

August 23

### **Middle School Parent Orientation**

7:00 p.m. - 9:00 p.m., Fellowship Hall

November 9 or January 27

### **New Parent High School Information Meetings**

8:30 a.m. and 7:00 p.m., High School Commons

May 14

### **End of Year Celebration Day**

May 22

### **Welcome Dance**

Eighth Grade students



## CLASS TRIPS

The spring class trip provides students with a unique educational experience that expands classroom learning and develops Christian character through involvement in group activities.

Class trips are learning experiences, so no alternative classroom activities or supervision will be provided for students who choose not to participate. Students not participating in the class trip will receive absences for those days.

Class trip expenses are not included in tuition. Parents will be billed and trips must be paid for in advance.

It is our goal that all students participate in the class trip. Students may forfeit the opportunity to participate if they do not display a reasonable amount of self-control and self-discipline. Parents will be contacted by the Middle School Office if a child's participation is in question.

## DON'T MISS THE BACK TO SCHOOL MIXER

Welcome Back Eagles!!

Come on out and enjoy pizza, video games, Go-Karts, Bumper Cars, Rock Wall, Laser Tag, and Miniature Golf with your friends at Amazing Jakes!

10:00 a.m. - 3:30 p.m.

August 12th.

Please turn in Field Trip forms and money to the Middle School office by Monday, August 8.

## CLASS TRIPS

### **Sixth Grade**

Three day, two night trip  
Pine Cove (via bus)

### **Seventh Grade**

Three day, two night trip  
San Antonio (via bus)

### **Eighth Grade**

Three day, two night trip  
Corpus Christi (via bus)



## ATHLETIC OPPORTUNITIES

### Baseball, boys

Season: March - May  
Practice Begins: March

### Basketball

Season: December - February  
Practice Begins: November

### Cheerleading

Season: August - April  
Practice Begins: August

### Drill Team

### Cross Country (6th Grade)

Season: August - October  
Practice Begins: August

### Football, 7-8 Grade

Season: August - November  
Practice Begins: August

### Golf

Season: March - May  
Practice Begins: March

### Soccer

Season: August - October  
Practice Begins: August

### Softball, girls

Season: March - May  
Practice Begins: March

### Swim (6th Grade)

Season: November - February  
Practice Begins: October

### Tennis

Season: January - April  
Practice Begins: January

### Track & Field (6th Grade)

Season: March - May  
Practice Begins: March

### Volleyball, girls

Season: August - October  
Practice Begins: August

If the season has begun before a student is accepted to POPCS, he/she will be allowed to participate in the sport if roster space is available.

If you have any questions about POPCS' Athletics, please contact the following individuals:

#### Earl Garland, Athletic Director

[earl.garland@princeofpeace.org](mailto:earl.garland@princeofpeace.org) | 972-447-0532 ext. 340

#### Theresa Woodall, Associate Athletic Director

[theresa.woodall@princeofpeace.org](mailto:theresa.woodall@princeofpeace.org) | 972-447-0532 ext. 431

#### Chad Henke, Middle School Athletic Director

[chad.henke@princeofpeace.org](mailto:chad.henke@princeofpeace.org) | 972-447-0532 ext. 415

## EXTRACURRICULAR ACTIVITIES

AMC8 Math Competition (Winter)  
Lutheran Schools Math Contests (January)  
PSIA (Spring)  
Science Olympiad (Winter and Spring)

## 8TH GRADE RECOGNITION

Students completing 8th grade will participate in a commencement celebration during the Middle School Closing Chapel service. The service honors eighth grade graduates for their accomplishments and allows their families to share this special milestone with them. The class valedictorian and salutatorian will be presented and all students who meet the requirements will receive a diploma.

## PE UNIFORMS

Middle School students must wear the mandatory uniforms for Physical Education (P.E.) class. To order a uniform set, return your completed order form with attached payment to the Athletic Department. Forms are available on the 2010/2011 School Year Information web page. Uniforms will be distributed on the first day of school. PE uniforms are not at Campus Outfitters.

## ENRICHMENT TRIPS

### FALL

Science Enrichment:  
Grand Canyon, Yellowstone, Yosemite

### SPRING

History Enrichment:  
Gettysburg, Williamsburg, Washington D.C.

### Spanish Enrichment:

Costa Rica

# HIGH SCHOOL

## IMPORTANT DATES

August 12

**High School Meet & Greet**  
9:00 - 11:00 a.m.

**Freshman Parent Meeting**  
7:00 p.m., High School Library

August 26

**High School Parent Orientation**  
7:00 p.m., High School Commons

September 24 and 25

**Homecoming Game - (24th)/Dance- (25th)**

January 29

**High School Dance**

May 20

**Welcome Dance**  
Freshman and Sophomore

May 23

**Award Chapel/Senior Recognition**

May 27

**High School Graduation**  
7:00 p.m.

April 30

**Prom**  
Junior and Seniors

## HIGH SCHOOL MEET AND GREET

The High School Meet and Greet allows students the opportunity to pick up their schedules, receive their locker assignment, meet teachers and visit with students. Students are encouraged to visit the High School anytime between 9:30 - 11:30 a.m., on August 12.



## CLASS FUND-RAISERS

Each class will participate in the following grade level fundraising activities. All funds will go towards funding school dances and will build towards that grade level's class trip.

### SENIORS

**Pizza** - Students will order and serve pizza on Wednesdays during lunch. Senior class parents will assist with delivery. One day during the week of Homecoming, seniors will sell and serve pizza and a soft drink to all students, Preschool - Grade 12, who place an order.

### JUNIORS

**Soft Drinks** - Students will provide and sell cans of soft drinks on Wednesdays during lunch.

**Mums** - Students and their parents will participate in making and selling Homecoming mums.

**Homecoming Shirts** - Students will sell shirts that students and teachers may wear to school on Homecoming Day.

### SOPHOMORE

**Dessert** - Students will provide and sell desserts on Tuesdays during lunch.

### FRESHMAN

**Donuts** - Students will provide and sell donuts on Mondays during break.

## OFF CAMPUS LUNCHES

Junior and Senior students have the opportunity to enjoy an off campus lunch. Senior students will have two off campus lunches a month; Junior students will have one off campus lunch a month during the second semester. Parents must complete and return a permission form for their child to participate. A master off campus lunch list is available on ParentsWeb.

## SUCCESS CENTER

The Success Center develops strategies and plans interventions to help students succeed. The center includes three specific programs: Academic Support (ASP), Behavior Disciplining (BDP), and Student/Teacher Mentor (STMP). Each program proactively helps students accept responsibility and make a commitment to change their actions/attitudes to become successful again. Student participation varies depending upon his/her needs.

## COLLEGE DAYS

Junior and Senior students are permitted to be absent from school to visit prospective colleges. Juniors are allowed two days; seniors are allowed three days. Arrangements need to be made through the High School Office one week in advance.

## COUNSELOR

The High School Counselor serves all students in a variety of ways. Every student will meet with the counselor at least once during the school year. Students will discuss class choices, PSAT, ACT, SAT testing, college options and choices, college scholarships and any other matters of interest – personal or school related. Students can make an appointment with the counselor for any reason, personal or school related. The counselor provides students and parents with guidance, counseling and facilitates communication. To make an appointment, parents may contact Patti Hurt, High School Counselor, at 972-447-0532 ext. 341 or [patti.hurt@princeofpeace.org](mailto:patti.hurt@princeofpeace.org).

## ADVANCED PLACEMENT (AP) TEXTBOOKS

All students enrolled in Advanced Placement classes will need to purchase their textbooks online. Textbook



## EXTRACURRICULAR ACTIVITIES

Band Program  
Fellowship of Christian Athletes  
Latin Club  
Mens' Prayer Group  
National Honor Society  
Spanish Club  
Spiritual Leadership Team  
Student Against Destructive Decisions (S.A.D.D.)  
Student Council  
TAPPS - Academic, Art and Music Competitions  
Quill and Scroll International Honorary Society  
The Young Men's Service League (YMSL)



## ATHLETIC OPPORTUNITIES

### Baseball, boys

Season: February - May  
Practice Begins: January

### Golf

Season: January - April  
Practice Begins: January

### Basketball

Season: November - March  
Practice Begins: October

### Soccer

Season: November - February  
Practice Begins: August

### Cheerleading

Season: June - April  
Practice Begins: June

### Softball, girls

Season: February - April  
Practice Begins: January

### Cross Country

Season: August - October  
Practice Begins: August

### Swim

Season: November - February  
Practice Begins: October

### Drill Team

Season: August - February  
Practice Begins: August

### Tennis

Season: January - April  
Practice Begins: January

### Football

Season: August - November  
Practice Begins: August

### Track & Field

Season: February - May  
Practice Begins: January

### Volleyball, girls

Season: August - October  
Practice Begins: August

If the season has begun before a student is accepted to POPCS, he/she will be allowed to participate in the sport if roster space is available.

If you have any questions about POPCS' Athletics, please contact the following individuals:

### Earl Garland, Athletic Director

[earl.garland@princeofpeace.org](mailto:earl.garland@princeofpeace.org) | 972-447-0532 ext. 340

### Theresa Woodall, Associate Athletic Director

[theresa.woodall@princeofpeace.org](mailto:theresa.woodall@princeofpeace.org) | 972-447-0532 ext. 431

### Chad Henke, Middle School Athletic Director

[chad.henke@princeofpeace.org](mailto:chad.henke@princeofpeace.org) | 972-447-0532 ext. 415

# DEVELOPMENT

## OVERVIEW

Since Prince of Peace Christian School's tuition and fees do not cover the complete cost of educating each student, the school relies upon generous donations and grants to help fill the gap. As a school family, we can work together to help fill this gap and continue to improve upon the school's exemplary education. Your extravagance of time, talent and treasure are greatly appreciated. To learn how you can become involved, please contact:

**Teri Rice, Development Director**

[teri.rice@princeofpeace.org](mailto:teri.rice@princeofpeace.org)

972-447-0532 ext. 497

## DISTRIBUTION OF FUNDS

All funds raised through development programs will be divided in a 60/30/10 split.

**Distribution of Funds**

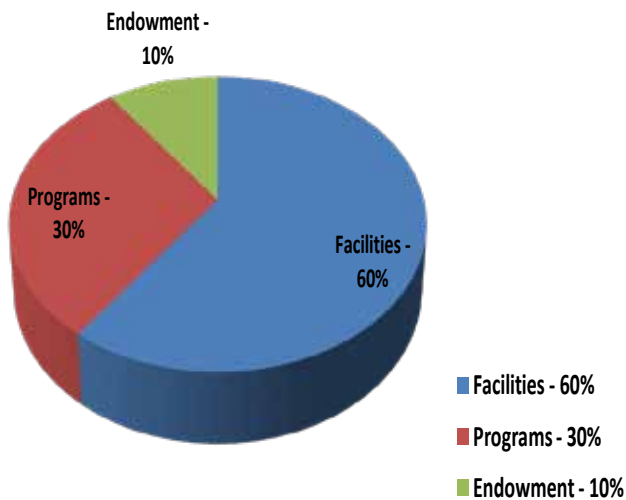

**Prince of Peace  
Christian School**  
*& Early Learning Center*

**Join us for the Next Discover POP Tour**

Tours meet in the Conference Room  
Please R.S.V.P. to Teri Rice at  
[teri.rice@princeofpeace.org](mailto:teri.rice@princeofpeace.org)

**Discover POP Tour Calendar**

August 24	8:30 a.m.
September 14	8:30 a.m.
October 12	8:30 a.m.
November 9	8:30 a.m.
December 14	8:30 a.m.
January 11	8:30 a.m.
February 8	8:30 a.m.
February 15	7:00 p.m.
March 8	8:30 a.m.
April 12	8:30 a.m.
May 10	8:30 a.m.

**January 9 (OPEN HOUSE)**  
2:00 p.m.

**January 25 and March 22**  
Prospective Parents Tour and Luncheon  
11:30 a.m.



# MAJOR SCHOOL EVENTS

---

## ANNUAL FUND AND

### PLEDGE EVENT



Save the Date - October 5th  
7:00 p.m. in Eagle Stadium

## THE LEGACY SOCIETY



*Prince of Peace Christian School  
relies on the generous support of  
partners in the development of our 21st century  
school of excellence. By Becoming a member of the  
Legacy Society, your multi-year pledges help us in*



## GRANDPARENTS' DAYS (November 18 & 19)

Students in Preschool 3 - Grade 8 will celebrate Grandparents' Day. Since students anticipate having a special friend joining them during the festivities, parents are strongly encouraged to make arrangements to have their child's grandparent(s) or a special friend(s) attend. By completing and returning the Grandparents' Day form, you will ensure your child's guests will receive a personal invitation. Grandparents' Day forms are included in the summer packet.

## AUCTION (April 9, 2011)



Mark your calendars for April 9, 2011, so you won't miss POPCS' gala event! The Annual Auction Gala is the premier social event and the largest fund-raiser of the year. The evening features a live and silent Auction, which includes over 800 items in all price ranges. Bidding begins a week prior to the event, with an online Auction that features class projects, teacher board items, parties and many other fantastic items. Online Auction items will not be available for purchase the night of Auction.

In order to ensure a successful event, we need your help! All families are encouraged to assist with their child's class project, which will be available for purchase in the online Auction. Gift gathering will begin in late January. During this time, families are asked to donate items to the Auction. All classes who achieve 100% participation will be rewarded with great prizes. No matter your time or talent, the auction committee has many volunteer opportunities available! **For more information, please contact Tori Rush, Director of Events, at [tori.rush@princeofpeace.org](mailto:tori.rush@princeofpeace.org) or 972-447-0532, ext. 412.**

## SPRING CARNIVAL (May 1)

More details to come!



# CARPOOL MAPS

## MORNING CARPOOL DROP-OFF

- ★ High School, 7:50 a.m.
- ★ Middle School – 7:50 a.m.
- ★ Preschool – Grade 5, 7:45 a.m.
- ★ Early Learning Center, 7:00 a.m. or 8:00 a.m.
- ★ Walk-In, 8:00 a.m.
- ★ Additional A.M. Drop-off, 8:00 a.m.
- ★ The Zone, 7:00 – 8:00 a.m.

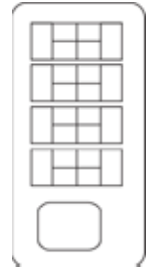

Athletic Fields

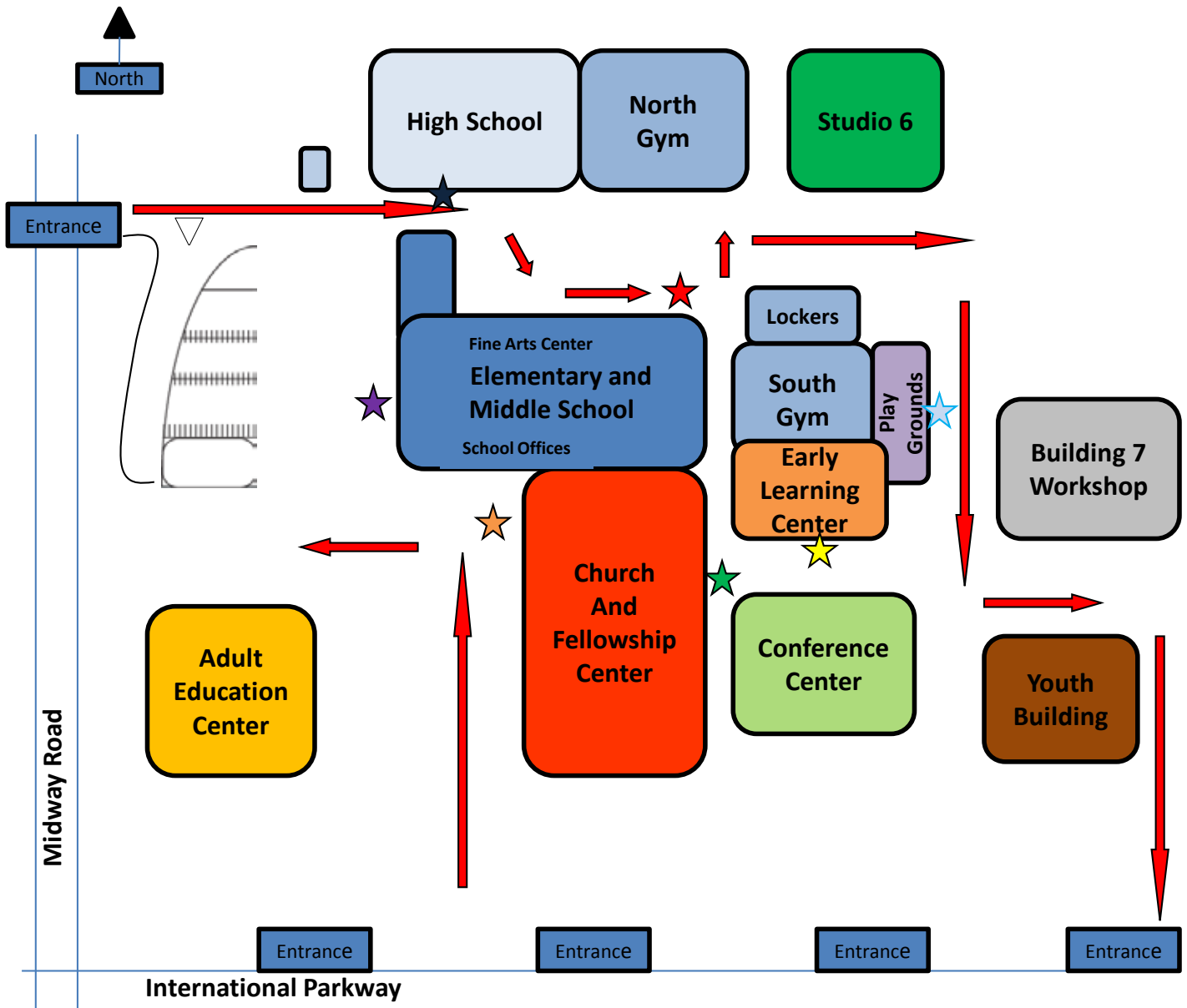

# CARPOOL MAPS

## AFTERNOON CARPOOL PICK-UP

- ★ High School, 3:30 p.m.
- ★ 1<sup>st</sup> Grade, 3:15 p.m.
- ★ Middle School, 3:30 p.m.
- ★ Kindergarten, 3:00 p.m.
- ★ 5<sup>th</sup> Grade, 3:15 p.m.
- ★ Preschool, 3:00 p.m.
- ★ 4<sup>th</sup> Grade, 3:15 p.m.
- ★ Early Learning Center
- ★ 3<sup>rd</sup> Grade, 3:15 p.m.
- ★ The Zone, 3:15 – 6:00 p.m.
- ★ 2<sup>nd</sup> Grade, 3:15 p.m.



Athletic Fields

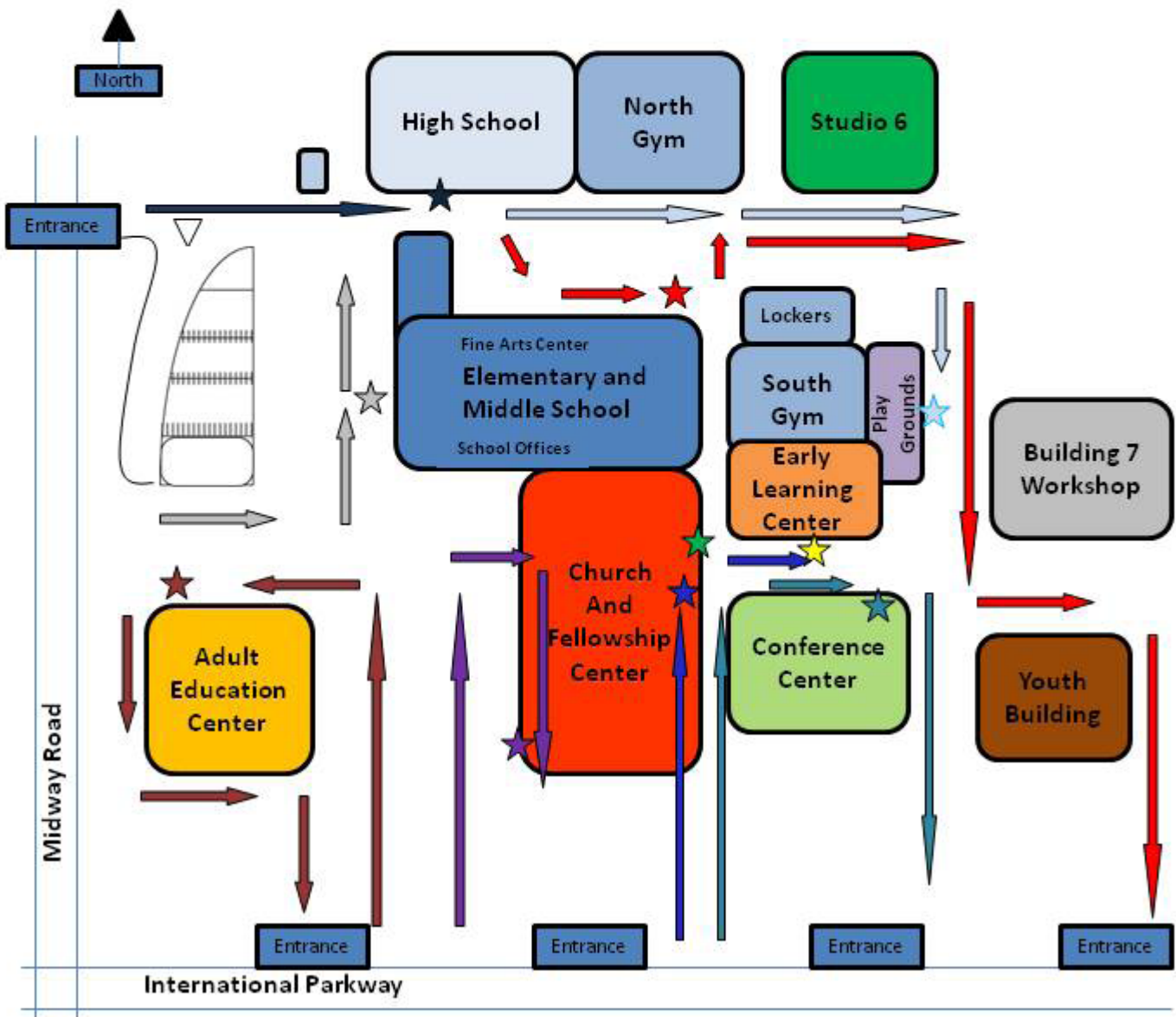

*Belong*

*Grow*

*Become*



Prince of Peace  
Christian School  
*& Early Learning Center*